	<h1>DATA SHEET</h1>			TSTI	<b>DS RNP 170010</b>	
				Rev.	C	
	Product code	<b>HT/QM QUICK CONNECT FLAT FAN SPRAY NOZZLE</b>	Dwg rev.	<b>C</b>	Date	16/03/2018
					Page	1 of 2

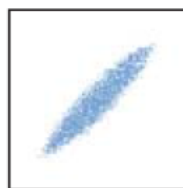

HT/QM flat fan spray nozzles, assembled onto a nipple with 3/8", 1/4" e 1/8" BSPT connections, offer the convenience of a quick coupling which allows a simple assembly. Moreover, the special seal between nipple and nozzle avoids any risk of leakage. To allow a perfect spray pattern alignment, the spray jet has an offset angle of 10° from the hexagon of the nipple onto which the nozzle is assembled. This type of nozzles are extremely convenient for maintenance and can be quickly replaced in case of clogging. The various flow rates of these nozzles are marked by different colours. They are made in glass fibre-reinforced PP to ensure maximum stability at high temperatures and chemical resistance. Temperature range: 0° to 95°.

**Typical Applications:**

- Washing:** filter cloth cleaning, parts cleaning, vehicles cleaning
- Lubrication:** spray of lubricants and release agents
- Agriculture:** spray of antifouling chemicals



Spray section

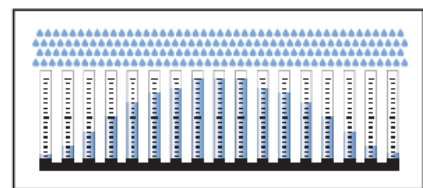

Convex distribution

**PNR coding**

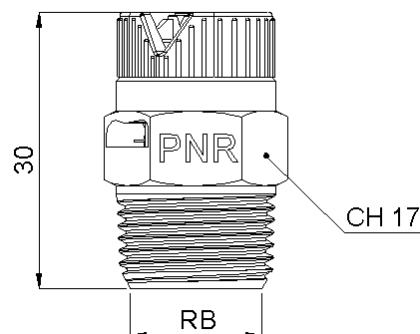
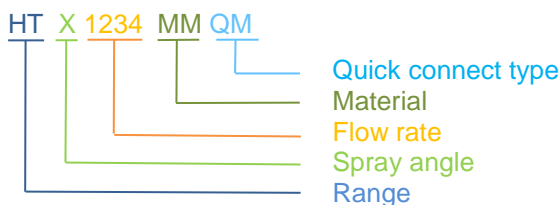

**Flow rate**

See table on next page

**Spray angle**

R = 65°      U = 90°  
J = 110°

**Material**

D6 = PP + 30% glass-fibre

**Quick connection type**

QM= Mini quick

	<b>DATA SHEET</b>			TSTI	<b>DS RNP 170010</b>	
				Rev.	C	
	Product code	HT/QM QUICK CONNECT FLAT FAN SPRAY NOZZLE	Dwg rev.	C	Date	16/03/2018
					Page	2 of 2

Angles	Code	Flow rate	Colour
<b>R=65°</b>  <b>U=90°</b>  <b>J=110°</b>	HTx 0390 D6QM	0,39	<b>White RAL 9003</b>
	HTx 0590 D6QM	0,59	<b>Red RAL 3020</b>
	HTx 0780 D6QM	0,78	Light grey RAL 7046
	HTx 1100 D6QM	1,0	<b>Brown RAL 8007</b>
	HTx 1120 D6QM	1,2	<b>Black RAL 9005</b>
	HTx 1160 D6QM	1,6	<b>Light orange RAL 2003</b>
	HTx 1190 D6QM	1,9	<b>Light green RAL 6019</b>
	HTx 1233 D6QM	2,33	<b>Light yellow RAL 1016</b>
	HTx 1310 D6QM	3,1	<b>Light blue RAL 5015</b>
	HTx 1390 D6QM	3,9	<b>Creamy white RAL 9001</b>
	HTx 1590 D6QM	5,9	Dark grey RAL 7015
	HTx 1780 D6QM	7,8	<b>Black-Brown RAL 8019</b>
	HTx 1980 D6QM	9,8	<b>Purple RAL 4010</b>
	HTx 2117 D6QM	11,7	<b>Dark Orange RAL 2001</b>
	HTx 2135 D6QM	13,5	<b>Lilac RAL 4001</b>
	HTx 2153 D6QM	15,3	<b>Dark green RAL 6032</b>
	HTx 2195 D6QM	19,5	<b>Yellow RAL 1023</b>
HTx 2230 D6QM	23	<b>Dark blue RAL 5013</b>	
HTx 2280 D6QM	28	<b>Pink RAL 3014</b>	

**Nipples available for nozzles HT/QM series:**

Nipple 3/8" BSPT  
ZHS V038 D6QM



Nipple 1/4" BSPT  
ZHS V025 D6QM



Nipple 1/8" BSPT  
ZHS V012 D6QM



Every nozzle type HT/QM, of any flow rate, can be assembled on all three types of nipples

**Examples of mini quick nozzles:**

